

UBI-2590SF / Short Format Dual Voltage

Technical Datasheet



Features

- Flexible dual mode output voltage
- SmartCircuit Technology - communication with host and charge equipment
- Accurate state-of-charge display for each side of the battery
- Rugged, military tough case construction can handle severe environments
- High energy density solution in the Ultralife

Applications

- Rugged, portable electronics
- Robotics / AUVs / UUVs
- Military communication devices
- AN/PRC-117G, AN/PRC-117F, AN/PRC-119, AN/PSC-5D

Optional Accessories

- CA0003: Vehicle Adapter
- CA0006: Series configuration, 2 conductor cable
- CA0007: Parallel configuration, 2 conductor cable
- CA0008: Independent configuration, 4 conductor cable
- CH0014: 12V Desktop Charger
- MRC-135A: Single Unit Solar Charger
- MRC-143A: 3-Unit Solar Charger
- UCA0039: Shielded Smart Cable
- UCA0114: Low Profile Smart Cable
- UCH0053: 6-bay Smart Charger
- UCH0054: 2-bay Smart Charger
- UCH0057: Smart Desktop Charger

Technical Specifications

Part No.	UBBL62	
NSN	TBD	
Voltage Range	24V Mode:	15.0V to 25.2V
	12V Mode:	7.5V to 12.6V
Nominal Voltage	24V Mode:	21.6V
	12V Mode:	10.8V
Capacity¹	Typical Capacity:	24V Mode: 5.8Ah 12V Mode: 11.6Ah
	Minimal:	24V Mode: 5.5Ah 12V Mode: 10.9Ah
Max. Continuous Discharge	24V Mode: 10.0A; 12V Mode: 20.0A	
Max. Pulse Discharge²	24V Mode: 18.0A; 12V Mode: 36.0A	
Energy Rating	63Wh (2X)	
Energy Density	Gravimetric: 167Wh/kg; Volumetric: 228Wh/L	
Weight	750g, 1.65lbs	
Cycle Life³	>300 cycles	
Operating Temperature	-32°C to 60°C discharging; -20°C to 50°C charging	
Storage Temperature	-20°C to 50°C	
Self-Discharge	< 5% per month	
Exterior/Housing	Hard plastic, black (Noryl N190X-701)	
Terminals/Connector	Connector SC-C-179495	
Communications	Physical Layer:	SMBus v1.1
	Protocol:	SBD v1.1 compliant
State of Charge Indicator	5-segment LCD display (both sections)	
Certifications	IEC 62133:2012 (CB ref. pending) UN 38.3	
Protection	Over Voltage:	4.30V (per cell)
	Under Voltage:	2.40V (per cell)
	Transient Currents:	23.0A > 15ms; 30.0A > 305us
	Short Circuit	
	Overcharge Protection:	Up to 40V
	Thermal Cutoff Device:	Activates 70±5°C; Resets 50±5°C
	Thermal Fuse:	Activates 93±5°C
Charging	Connect each side of the battery to a DC power source using correct polarity and apply a maximum voltage of 16.8V. Limit the current to the recommended rate of 3.0A and hold to 16.8V until the current declines to 300mA. Maximum charge rate is 4.8A.	
Safety	Material Safety Datasheet - MSDS041 Safety Guide UBM-5112	
Transportation⁴	Excepted Dangerous Goods UN3841: Packed with or contained in equipment Air Shipment: Packing Instruction 966 and 967, Section II Class 9 Dangerous Goods UN3480: Bulk shipment Air shipment: Packing Instruction 965, Section IB	
Harmonized Tariff Schedule	8507.60.0020	

Notes

1. Using a C/5 discharge rate at 25°C.
2. Load has a pulse width of 5 seconds with a total period of 30 seconds.
3. Number of consecutive C/5 rate discharges while in 24V mode and recommended charges of 25±5°C until the battery reaches 80% of initial capacity.
4. For bulk shipments by air that are no more than two batteries and one package, this cell is Excepted Dangerous Goods and can be shipped under Packing Instruction 965, Section II.

UBBL62

Newark, New York | +1 315-332-7100 | Fax: +1 315-331-7800

©2018 Ultralife Corporation • www.ultralifecorp.com • All information is subject to change without notice.

The information contained herein is for reference only and does not constitute a warranty of performance. • 05 MAR 18 UBM-0083 Rev: C

Dimensions

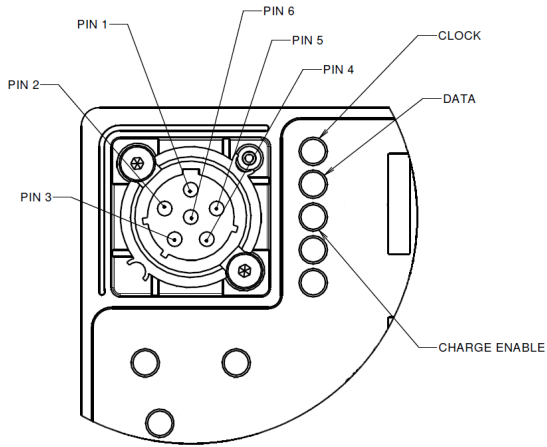
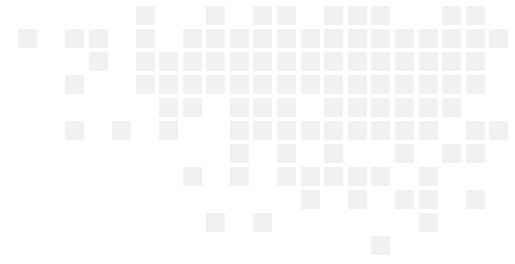

DETAIL A

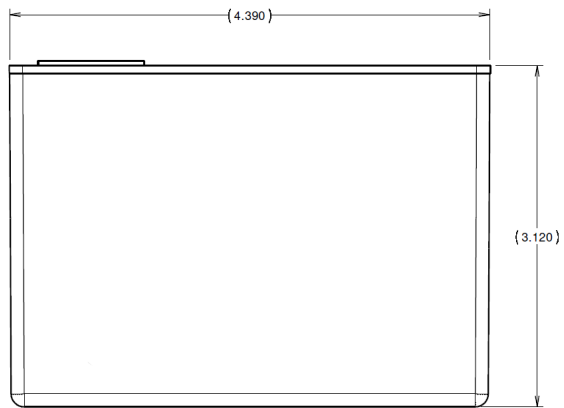
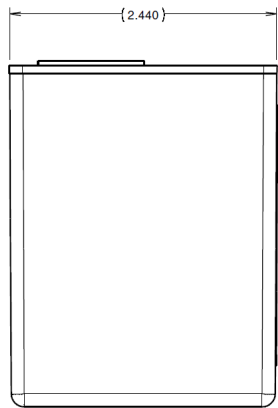
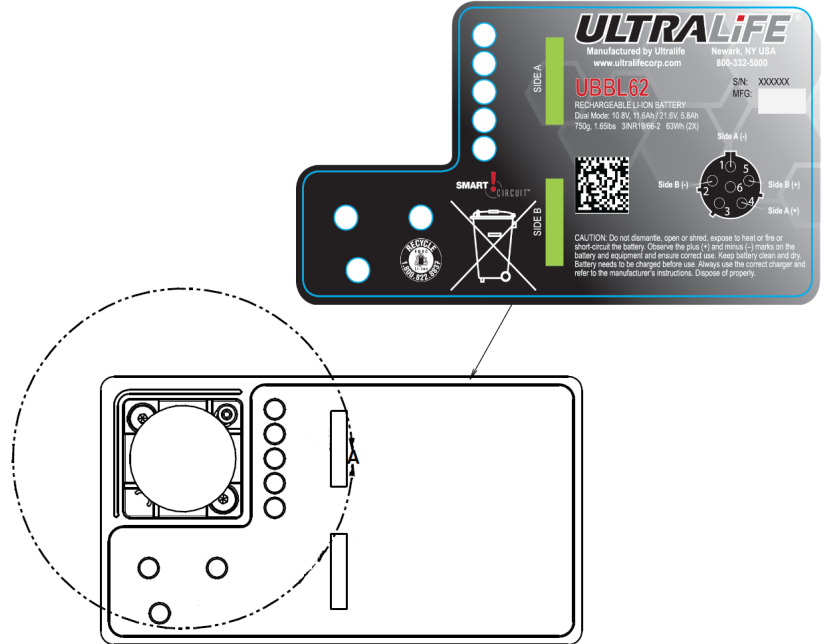

UBBL62

Newark, New York | +1 315-332-7100 | Fax: +1 315-331-7800

©2018 Ultralife Corporation • www.ultralifecorp.com • All information is subject to change without notice.

The information contained herein is for reference only and does not constitute a warranty of performance. • 05 MAR 18 UBM-0083 Rev: C

Performance Graphs

