

UI15H01011 BATTERY

Technical Datasheet

Technical Specifications

Part No.	UI15H01011
Battery	Lithium Iron Phosphate (LiFePO4)

Electrical Parameters

Nominal voltage	48V
Nominal capacity	250Ah
Max. charge current	50A
Max. charge voltage	54.75V
Cont. discharge	50A
Peak discharge	50A
Life expectancy @ 25°C 0.2C Charge/0.2C Discharge	>2000 cycles with min 80% of initial capacity
Energy	12 KWh

Safety Parameters PCM

Over-charge detection voltage	3650mV/cell ± 0.025 Volts
Over-discharge detection voltage	2500mV/cell ± 0.063 Volts

Operating temperature	0°C to 45°C (charge) -20°C to 60°C (discharge)
Storage temperature	-20°C to 60°C max -20°C to 20°C recommended

Physical Parameters

Length	915mm
Width	450mm
Height	295mm
Weight	150Kg
Contacts Output	Flying Leads
Enclosure	Sheet Metal Power Coated

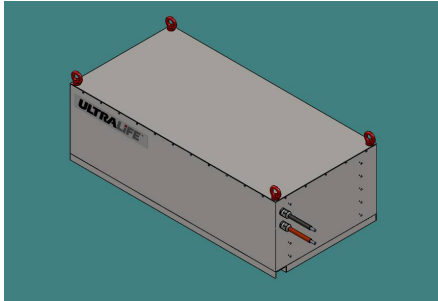

Features

- High energy density.
- Built-in Protection Module
- Comprehensive charging/ discharging and passive safety systems.
- State of charge indicator with Voltage based

Application

- Suitable for use with Tow Trucks and Industrial Robotics

Dimensional Drawing

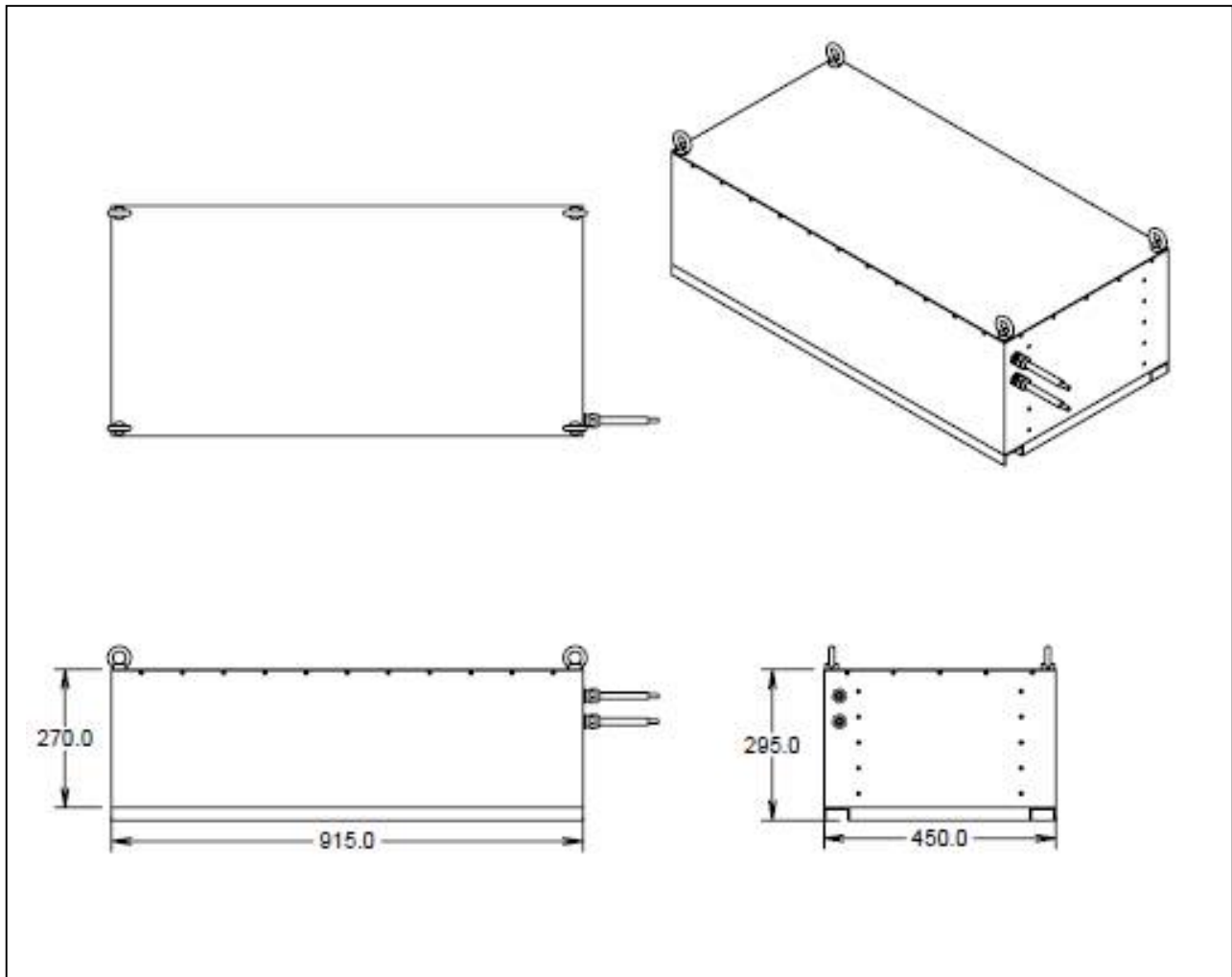

UI15H01011

Ultralife Batteries India Private Limited

No. 38B1 Part, Doddanakundi Industrial Area, 1st Phase, Mahadevapura, Bangalore 560 048

Phone : +91 80 28524680 , +91 80 28524690

05 February 19 UI15H01011 Rev:0

Page 2 of 2